

artacent[®]

APPLICATION GUIDE

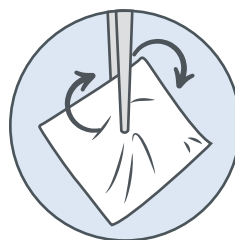

1. Ensure the wound is free of active infection and then **prep the wound site**. *Do not use Betadyne.



4. Open the sterile sealed pouch and **place allograft** using either side directly on the granular bed of the wound.

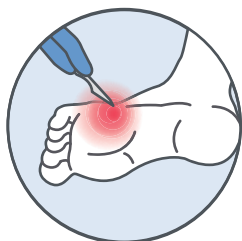

2. **Debride wound**, removing all the necrotic (dead) tissue.



5. **Anchor** allograft using preferred method of fixation. Apply **non-adherent bandage** to cover allograft. Then **wrap** the area with gauze. *Optimal dressings promote moisture balance and provide exudate control.



3. Open the outer peel pouch and deliver the innermost sterile sealed pouch containing the allograft material to a **sterile field**.



6. **Evaluate wound** and repeat application weekly or at the discretion of the health care provider.

APPLICATION GUIDE FOR:

artacent wound[®] & artacent ac[®]
advanced products of

tidesmedical

advanced products. expert service.

Want to learn more? Our team is available by phone at **888-494-4441** and email at info@tidesmedical.com.