

artacent[®]

WOUND

APPLICATION GUIDE



1. Ensure the wound is free of active infection and then **prep the wound site**. *Do not use Betadyne.

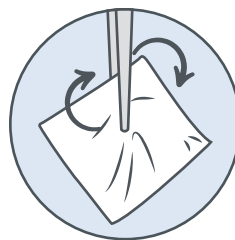

4. Open the sterile sealed pouch and place **Artacent Wound[®]** using either side of the allograft directly on the granular bed of the wound.

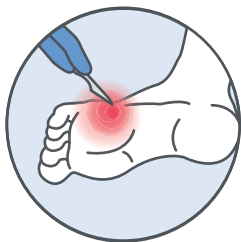

2. **Debride wound**, removing all the necrotic (dead) tissue.



5. Anchor Artacent Wound using preferred method of fixation. Apply **non-adherent bandage** to cover Artacent Wound. Then **wrap** the area with gauze. *Optimal dressings promote moisture balance and provide exudate control.



3. Open the outer peel pouch and deliver the innermost sterile sealed pouch containing the allograft material to a **sterile field**.



6. **Assess wound** and repeat dressing and off-loading weekly as necessary.

tidesmedical

advanced products. expert service.

888-494-4441

www.tidesmedical.com

Want to learn more? Our team is available by phone at **888-494-4441** and email at **info@tidesmedical.com**.